

# BIOMETRIC TERMINAL FOR T&A AND SIMPLE ACCESS CONTROL



## BIO TIME 2

- ▶ High-Density PVC Housing.
- ▶ Color Screen.
- ▶ Fingerprint, Password, Proximity Card.
- ▶ USB-Host, Network (TCP/IP)
- ▶ New Connectivity: Wi-Fi
- ▶ Simple Access Control
- ▶ 3,000 Fingerprints, 3,000 Proximity Cards, and 50,000 Records



**BioTime 2** is a biometric terminal with a 2.8-inch color screen, designed for managing Time and Attendance and basic Access Control applications. It includes the **Z-ID fingerprint reader** for effective recognition and verification, as well as internal Wi-Fi for convenient communication.

**BioTime 2** can be managed through its **TCP/IP network interface**, Wi-Fi, or via its USB port for manual data transfer to avoid the risk of accidental data deletion. It can be easily managed via **RS232/485, TCP/IP, and USB-Client**, and it also has a backup and data recovery function to prevent loss of information in case of accidental deletion.

**Wi-Fi:** The integrated Wi-Fi module operates on the 2.4G radio band and complies with IEEE 802.11b/g/n standards.

**Z-ID:** Employing the Z-ID fingerprint reader to achieve excellent recognition. It works well with dry, wet, and rough fingerprints.

**ADMS:** Optional for devices used globally. Resolving the device's limited capacity through the HTTP network. Devices can connect, charge, and copy data automatically. This is useful for management and monitoring devices.

**USB:** Supports USB-Host connection for backing up and managing information when the device is standalone.



# BIOMETRIC TERMINAL FOR T&A AND SIMPLE ACCESS CONTROL



## BIO TIME 2

### SPECIFICATIONS

- Part Number: BIOTIME 2
- Fingerprint Capacity: 3.000
- Card Capacity: 3.000 (optional)
- Card Reading: RFID de 125 Kz.
- Event Capacity: 50.000
- Screen: 2.8-inch color screen.
- Communication: TCP/IP, Wi-Fi, USB-Client.
- Standard Functions: SMS, daylight saving time, web server, scheduled bell, work code, automatic status change, self-service search, T9 input, 9-digit ID.
- Optional Functions: ID/IC Card, ADMS, External Printer RS232.
- Power Supply: DC 12V/1.5A
- Operating Temperature: 0 °C - 45 °C
- Verification Humidity: 20% - 80%
- Dimensions: 185 x 137 x 38.2 mm

### CONFIGURATION

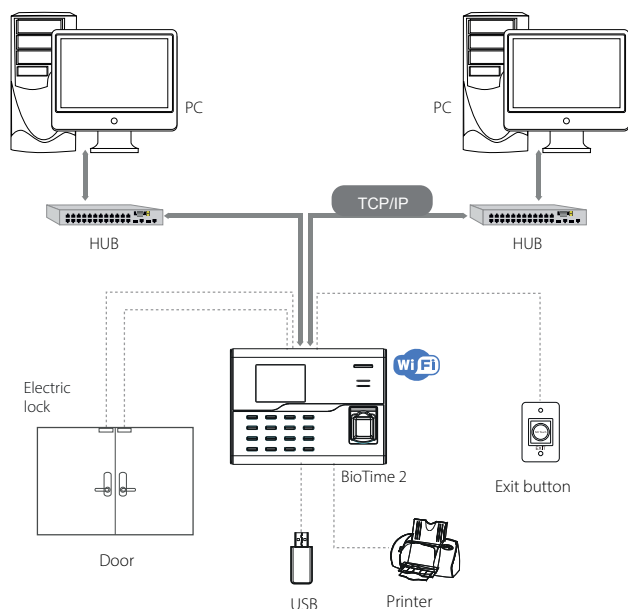

### INTERFACE

